

# Disco-Rückschlagklappe BV 36



## MATERIAL

BV36

-XX XX X

Body		
Cast steel	45	A216 WCB, Zn plated
Stainless steel	66	CF8M

  

Disc		
Cast steel	45	A216 WCB, Zn plated
Stainless steel	66	CF8M

  

Seat	
EPDM	E
NBR	B
FKM/FPM	V
PTFE	T
METAL	M

## DIMENSIONS

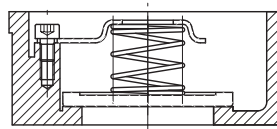
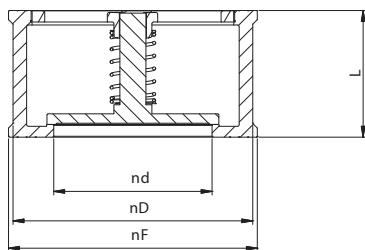

DN 15 - DN 100

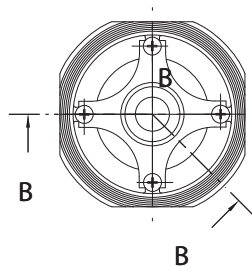

DN 125 - DN 300

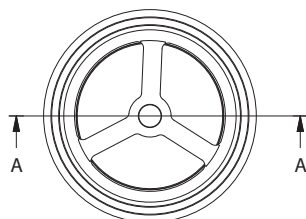

DN	NPS	PN40			
		D	d	F	L
15	1/2	43	15	53	16
20	3/4	53	20	63	19
25	1	63	25	73	22
32	1 1/4	75	30	84	28
40	1 1/2	86	38	94	32
50	2	95	47	107	40
65	2 1/2	115	62	126	46
80	3	131	77	145	50
100	4	150	96	164	60
125	5	180	119	190	90
150	6	209	141	219	106
200	8	272	190	282	140
250	10	317	225	317	145
300	12	369	280	380	160
<b>mm</b>	<b>inches</b>	Dimensions in mm			

all dimensions are subject to revision without prior notice